



141 Cherry Springs Drive Asheville, NC 28804

BEDROOMS

3

BATHROOMS

2 1/2

CAR GARAGES

1

HEATED SQ. FT.

1,640

PRICE

442,000

Interior Highlights

- Open Concept Main Living Area
- Soft Close Cabinets
- Stainless Steel Appliances
- Primary Suite on Main Level with Vaulted Ceilings
- Quartz Countertops
- Upgraded Lighting Package
- 3 Bedrooms, 2 1/2 Baths

Exterior Highlights

- Craftsman Style Front
- Single Car Garage
- Private Patio
- Interior Unit
- Lawn Maintenance Included in HOA





Floorplans

The Lily 1500 Plan - First Floor

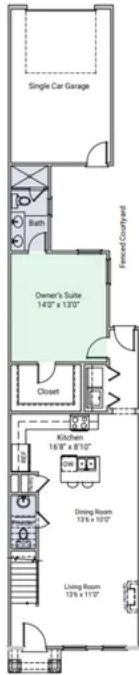

The Lily 1500 Plan - Second Floor

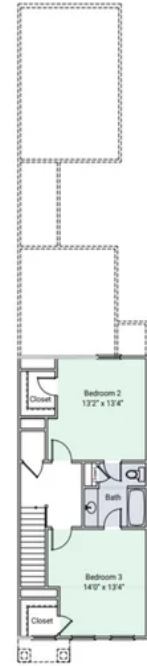



The Lily 1600 Plan



4.12.24



Gallery

Representative Photo

