

TOWNS AT ASPEN STATION

TULIP PLAN (INTERIOR UNITS)

Two-story Brick Colonial Townhomes with 3 bedrooms and Master on Main Level

FLOOR PLAN HIGHLIGHTS

- 1,574 heated square feet
- Master bedroom on Main
- Great Closets in all bedrooms
- Granite counters throughout
- Wide Plank Wood Flooring
- Interior Unit



INTERIOR HIGHLIGHTS

- Granite Countertops
- Stainless Appliances
- Tile Shower with Bench
- White cabinets
- Kitchen Backsplash



EXTERIOR HIGHLIGHTS

- Brick Facades with great detailing
- Private Courtyard
- James Hardie Siding/Shakes
- Great Curb Appeal
- Full Exterior Maintenance



SONNY CRATER
980-233-1239

sonny@madisonsimmonshomes.com

TOWNS AT ASPEN STATION

TULIP PLAN

Fenced area for A/C unit, and rollout garbage

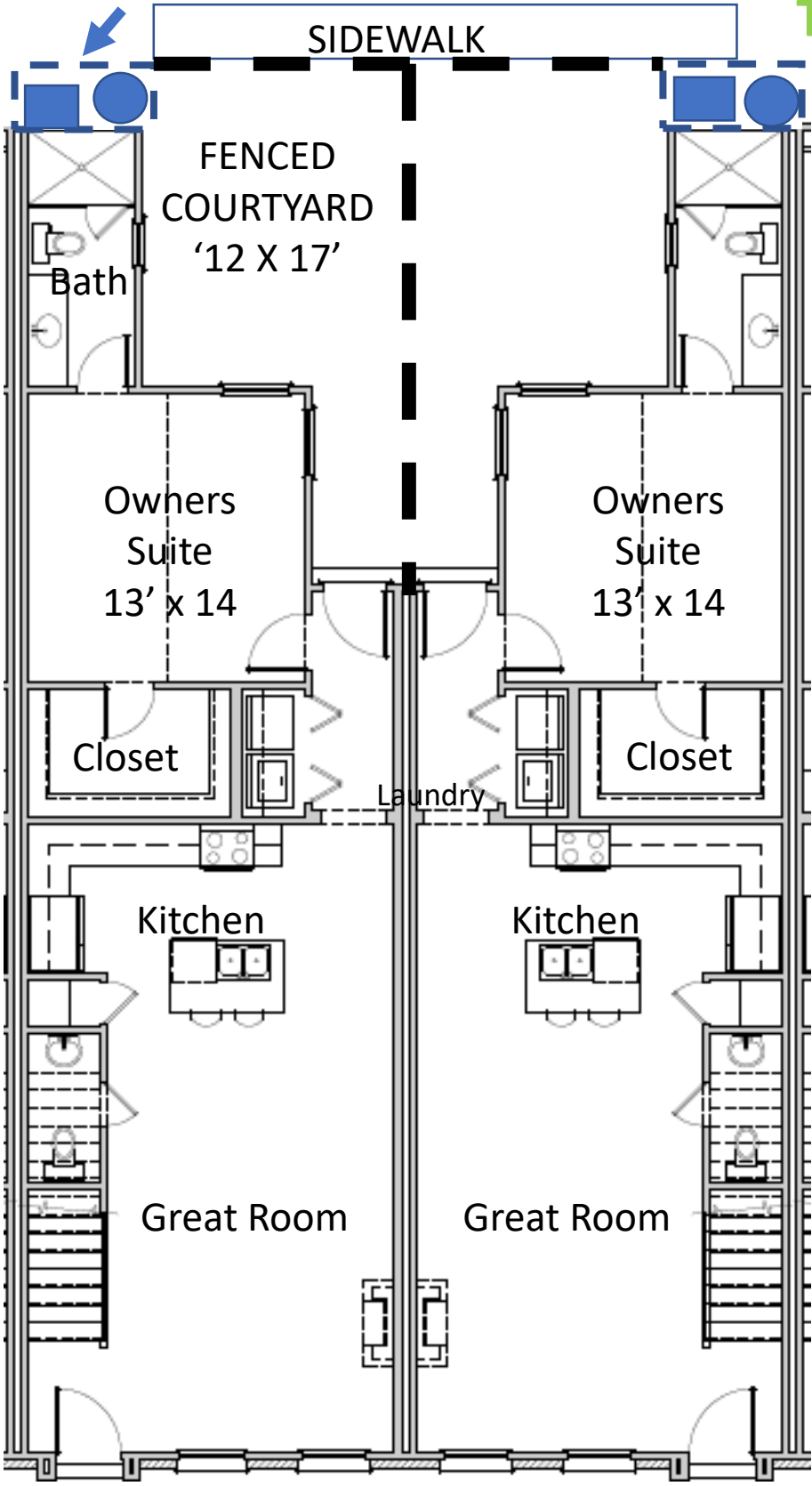

FIRST FLOORS FOR BOTH MIDDLE UNITS

SECOND FLOOR FOR RIGHT HAND UNIT.

LEFT HAND SECOND FLOOR IS MIRROR IMAGE

